



VANCOUVER WESTSIDE & DOWNTOWN SPECIALISTS



Les Twarog 604.671.7000  
 Sonja Pedersen 604.805.1283  
[www.lestwarog.com](http://www.lestwarog.com)

我们将竭诚为您提供最优质的服务。请致电我们的经纪人：Jimmy Ng 778-788-0013



**WATERFRONT PENTICTON HOME**  
 167 Elm Avenue \$2,100,000

Beautifully remodelled immaculately kept, 2000sf, 2 bed, 2 bath rancher on a double, 18,600sf lot right on the waterfront of Skaha Lake. Home features hardwood floors, rec-room with 12ft ceilings and wood burning FP, gas FP in Livingroom, crown mouldings, double garage and lots of storage.



**WILLOUGHBY LAND ASSEMBLY**  
 LANGLEY, BC - 1.5 ACRES  
 21427 83 Avenue \$3,199,000

1.51 Acre lot with 4200 S/F 2 level home & a huge garage/storage. Property has farm status-raising sheep and chickens. Currently zoned SR-2, ppts on west side also available for possible land assembly.



**SOUTH VANCOUVER HOME**  
 362 E. 56th Avenue \$1,688,000

Great family home in a quiet neighbourhood in South Vancouver - 5-Bdrms (3 up, 2 down) 4 Baths over 1,932 sq ft. Downstairs has additional kitchen with separate entrance - possible basement suite conversion. Features city views from the large deck, fenced yard and detached double garage.

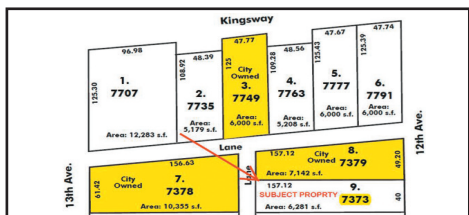

**BURNABY LAND ASSEMBLY**  
 7373 12th Avenue \$1,950,000

Part of a 9 lot land assembly totalling 62,799sf (over 40,000 passing vehicles/day) Under the OCP the City of Burnaby MAY allow a change in zoning to CD which allows high density residential.



**MOVING & TRUCK RENTAL COMPANY**  
 295 Terminal Avenue \$660,000

Dysco established in 1999 with large commercial and residential clientele base - selling goodwill, North American trademark and valuable lease opportunity. Located on a 12,000 sf downtown property, housing 30 mechanically sound trucks that are leased out at \$6000/month (\$200/truck) or outright purchase for an extra \$400K (new over \$2.5M).



**EL CERRITO - LA PAZ, MEXICO**  
 Development Site \$4,000,000 USD

71 acres located ten minutes from the DT La Paz, less than thirty minutes from the International Airport and two hours from Cabo San Lucas. Go to <http://www.6717000.com/lapaz/> for info package.

**SQUAMISH**  
**104 ACRE LAND ASSEMBLY**  
**\$16,000,000**

"Paradise Trials" a unique equestrian community located in the Chekamus Valley, Squamish BC consisting of 82 serviced lots and a proposed 10 Acre horse riding centre. More info at [www.6717000.com/squamish](http://www.6717000.com/squamish)

**LAND ASSEMBLY**  
**GIBSONS**  
**92,000 sf**

**GIBSONS DEVELOPMENT SITE**  
 895 - 909 Gibsons Way \$7,500,000

895 Gibsons Way, Cedars in Hotel and Convention Centre on a 62,000 sf lot. 909 Gibsons Way, Gibsons Cinema sits on a 30,000 sf lot. Great development opportunity, only a 7 minute drive from the Langdale ferry terminal on the Sunshine Coast.



**LARGE RETAIL BUILDING**  
 BELLINGHAM, WA  
 4260 Cordata Pkwy \$3,995,000 USD

14,973 sqft retail building in Bellingham, WA. Located near large, popular retailers like Best Buy, T.J Maxx, Office Depot & more. Fast growing Cordata neighbourhood with lots of potential. Call or email for info package.





Les Twarog 604.671.7000  
 Sonja Pedersen 604.805.1283  
[www.shaughnessyproperties.com](http://www.shaughnessyproperties.com)



SHAUGHNESSY PROPERTIES

VANCOUVER LUXURY HOMES

[www.shaughnessyproperties.com](http://www.shaughnessyproperties.com)



我们将竭诚为您提供最优质的服务。请致电我们的经纪人：Jimmy Ng 778-788-0013



**3589 GRANVILLE**

Call for price

Rocklands Mansion - A stunning example of Vancouver history, this Heritage A designated 9000 sqft mansion sits on 3/4 of an acre of prime Shaughnessy parklike setting. This beautiful home has been completely restored with all of its heritage features intact and all the modern day comforts to be expected. From the sun-drenched kitchen featuring sub-zero and Miele appliances, upgraded wiring, plumbing & heating / Air Conditioning. 8 completely renovated bathrooms, original leaded glass windows, oak & mahogany woodwork plus remote window coverings throughout. This home is a 10 inside and out. Seller willing to do a VTB – call for details.



**1138 MATTHEWS**

OFFERED AT \$17,980,000

First Shaughnessy home designed by Matsuzaki Wright sits on almost 22,000 sf of beautifully landscaped park like gardens with lush south facing back yard, one of the most coveted addresses in the city. 6,000 sf 5 bed, 5 bath home has updated gourmet chef's kitchen and beautiful oak hardwood floors. Steps to Osler Blvd and The Crescent.



**68 - 4900 CARTIER**

OFFERED AT \$2,638,000

Quiet corner TH in Shaughnessy Place with 24 hr guarded entry, located just behind the Van Dusen Gardens. This 3 bdrm & den unit features approx. 2400 SF living space + 800 SF attached 3 car garage, one of the largest floor plans in the complex. Bright and airy, this unit boasts spacious rooms, large windows on all 3 sides & vaulted ceilings in the living room. Outdoor space includes private balcony off the master, garden deck and wrap around patio.